

Italswiss



Packer IS

Packer idraulico / Hydraulic packer

PACKERS IDRAULICI / HYDRAULIC PACKERS

Sono stati concepiti appositamente per risolvere brillantemente i problemi di iniezioni cementizie. Una pompa manuale (oppure elettrica 230V) aziona il pistone idraulico che comprime i due elementi in elastomero speciale trattenuti da anelli in acciaio dello stesso diametro, le gomme espandendosi ottimizzano la tenuta all'interno di micropali valvolati e tubi a «manchettes». Possono essere utilizzati come packer semplici o doppi a seconda della necessità con una semplice azione di spostamento degli elementi. I pacchi espansione dei nostri packers idraulici sono intercambiabili tra di loro e permettono, con una spesa minima, l'utilizzo in micropali o tubi di diversi diametri.

They were constructed deliberately to solve the problems during the cement injections. A hand-pump (or 230V electric pump) starts a hydraulic piston which compresses two special elastomer elements attached to steel rings with the same diameter. While stretched, rubber optimizes the leak-tightness inside the micropiles and tubes fitted with valves. After simple shifting of some elements, they can be used as a single packer or a double one, depending on needs. The rubber rings of our hydraulic packers are interchangeable, so it is possible to use them with tubes and micropiles of different diameters, which reduces expenses

1 Anello di sollevamento / Lifting eye
2 Foro lavaggio* / Washing hole *
3 Raccordo iniezione cemento / Cement injection connector
4 Raccordo olio idraulico / Oil connection
5 Anello acciaio / Steel ring
6 Distanziatore / Spacer
7 Gomma espansione / Rubber
8 Cilindro idraulico / Hydraulic cylinder
9 Stelo con foro iniezione / Shank with an injection hole
10 Dado di bloccaggio / Locknut
* Solo su modelli IS 58 - IS 78 e IS110
* Only with models IS 58 - IS78 and IS110

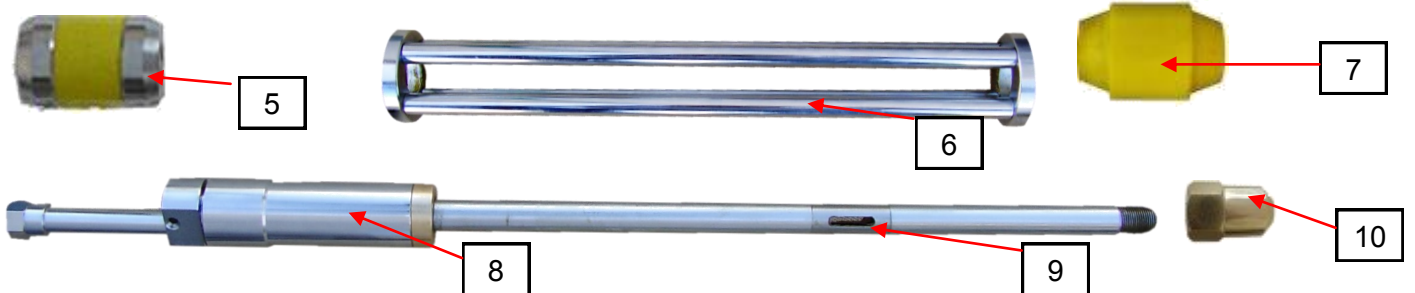
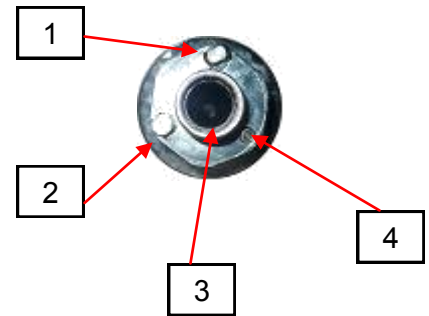



Packer singolo / Single packer

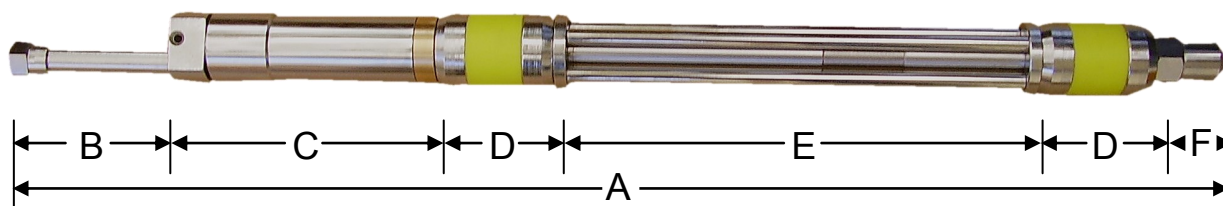

Packer doppio / Double packer



Modello Model	Dimensioni / Dimensions mm						Peso Weight
	A	B	C	D	E	F	Kg.
IS 24	529	90	162	42	200	35	1,1
IS 32	634	102	170	75	250	40	2,0
IS 45	697	102	175	95	300	45	3,3
IS 58	777	60	172	95	405	50	7,6
IS 78	890	60	172	95	405	50	13,4
IS 110	1022	60	192	95	500	60	22,0

 Pacco espansione / Spare rubber	Packer	Elemento espansione / Rubber ring min. mm	Elemento espansione / Rubber ring max. mm	Raccordo tubo idraulico / Hydraulic tube connection	Raccordo tubo iniezione / Injection hose connection	Pressione idraulica / Hydraulic pressure min/max bar
	 Kit gomme / Rubber Kit	IS 24	24	35	GAS 1/8"	GAS 1/8"
IS 32		32	45	GAS 1/8"	GAS 1/4"	250/500
		35	60			
IS 45		45	60	GAS 1/8"		250/500
		50	65			
IS 58	58	75	GAS 1/8"	GAS 1/2"	250/500	
	68	85				
	78	95				
	88	105				
IS 78	78	92	GAS 1/4"	GAS 3/4"	250/500	
	88	105				
	98	116				
	110	130				
	124	144				
	135	155				
IS 110	148	168	GAS 1/4"	GAS 1 1/4"	250/500	
	158	178				
	168	188				
	188	208				

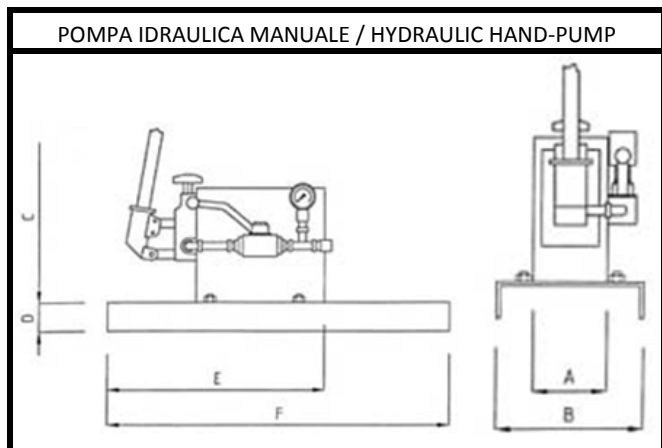

Modello / Model	Dimensioni / Dimensions mm						Peso / Weight
	A	B	C	D	E	F	Kg.
ISP 12	100	200	150	50	370	650	11

Capacità / Capacity lt.	2
Portata max. / ciclo Maximum Flow rate/ cycle	12
Pressione / Pressure max. Bar	380

	Ø interno Ø inside mm	Ø esterno Ø outside mm	Pressione esercizio Wor- king pressu- re bar	Pressione scoppio Bursting pressure bar	Lunghezza Length metri	Raccordi Connectors
	4,8	10,5	210	840	25	1/8 GAS
	6,3	13,5	400	1600	25	1/4 GAS